

How-to Connect a Brailiant to an iPad

Turn on the Brailiant via the Power Button on the right side



On iPad, Open Settings



Click General → Accessibility

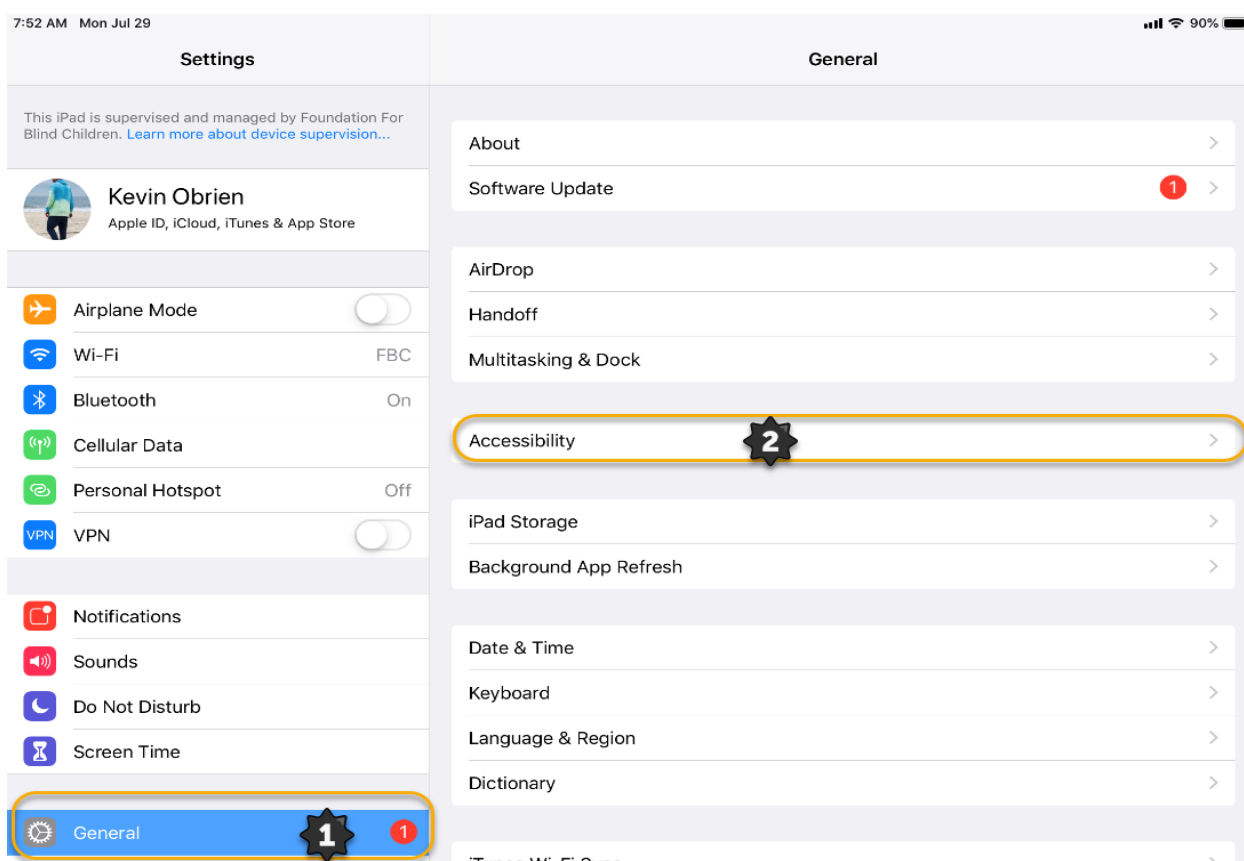

Click VoiceOver

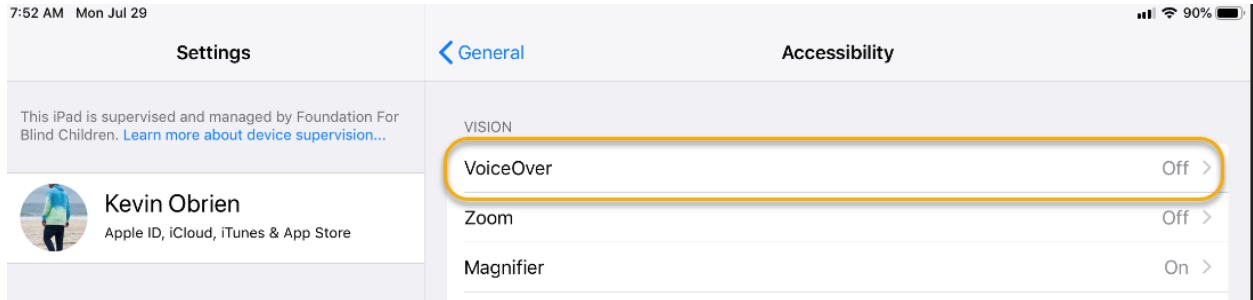

Turn on VoiceOver with the Toggle button, and then click Braille

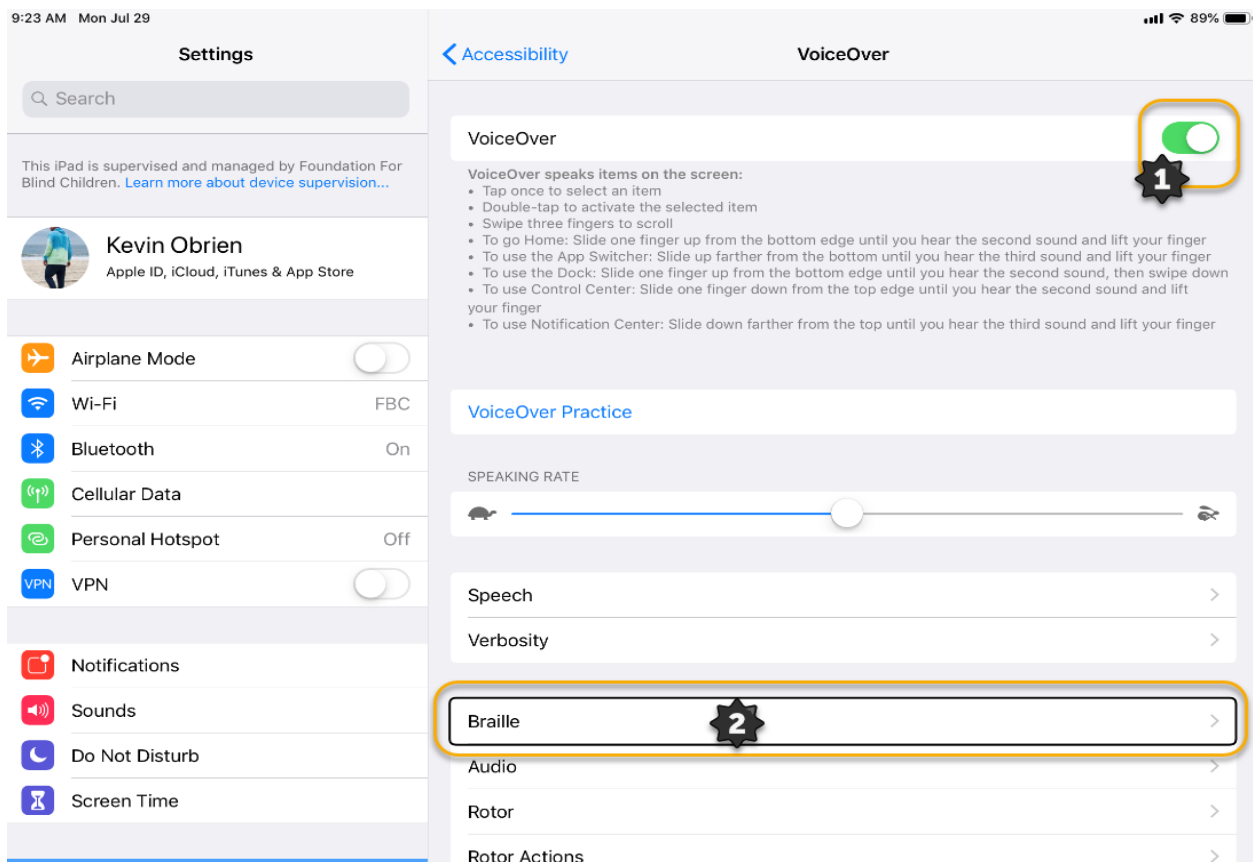

Now choose your Braille display (Brailiant BI 40)

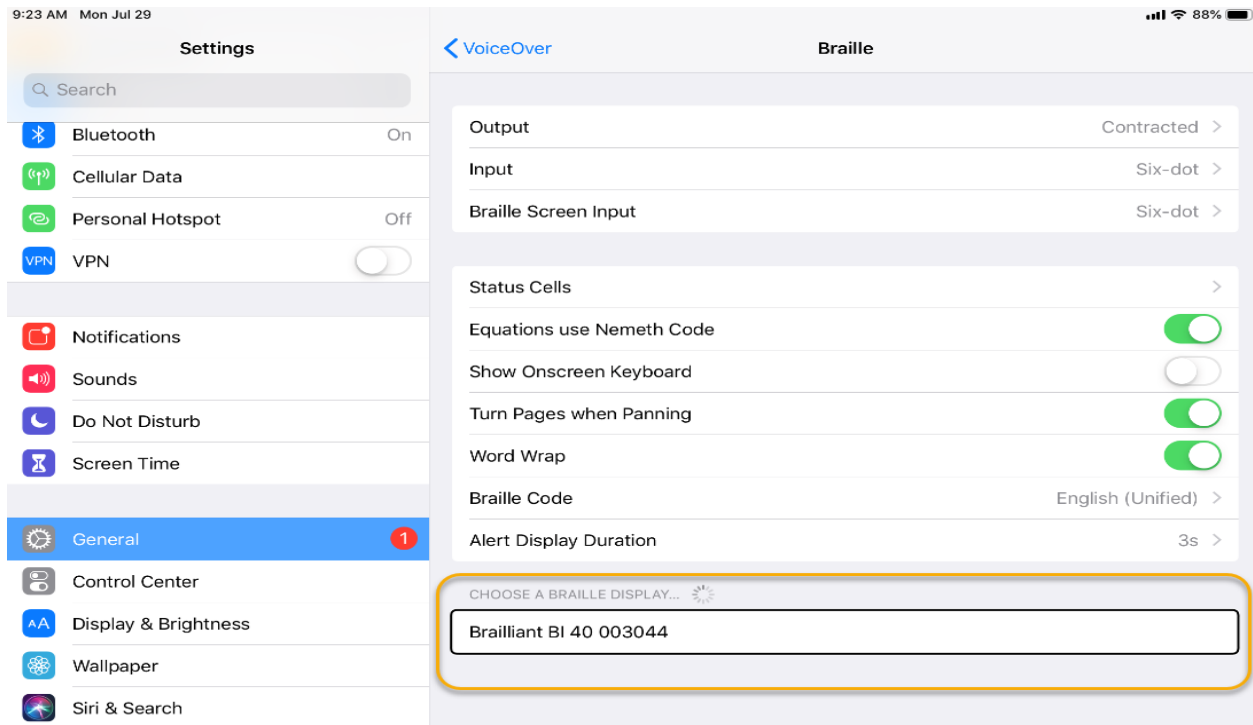

There will now be a popup to pair device, click Pair

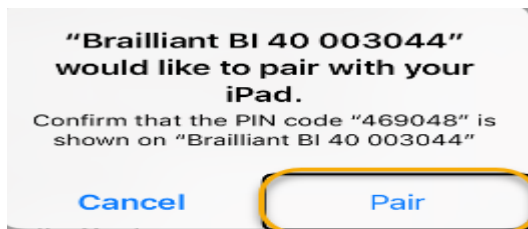

You have now finished pairing your Braille display. Change your Output, Input, and Braille Screen input to preferred settings



Resources

[Brailiant \(BI and B\) and iOS devices \(online web page\)](#)